

Since the usage and finishing of the product is not under our control, we accept no liability for the success of the work and can therefore only guarantee the nature of our products as per the accompanying product data sheets and in accordance with our general terms and conditions of sale. The properties listed here represent no guarantee with respect to the eventual use of our products. We reserve the right to make changes due to technical advances. Any other technical information given in the course of a consultation must be confirmed in writing. Colours shown here are restricted by the printing techniques and may differ from those exhibited by the products themselves. We also reserve the right to make alterations to the product technology or design. Only the current version of this data sheet is valid. Such versions are accessible by anyone via the internet. The issue of the latest data sheet invalidates all those that have been published beforehand.

Durabase CI-FH

1/2

Decoupling mats for Electric Underfloor Heating

- INSTALLATION INSTRUCTIONS -

Installation
Instructions

DURAL

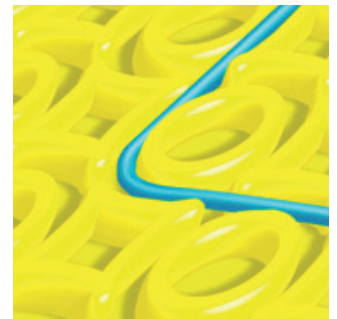
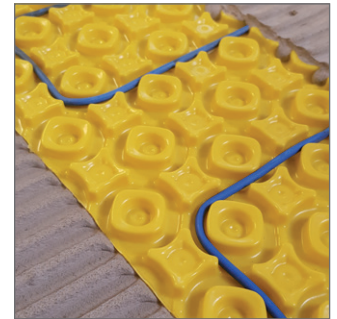
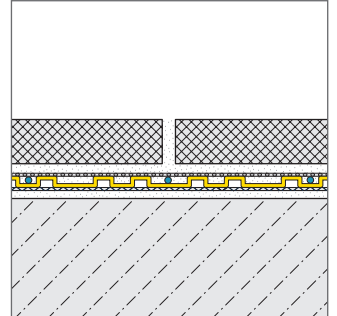
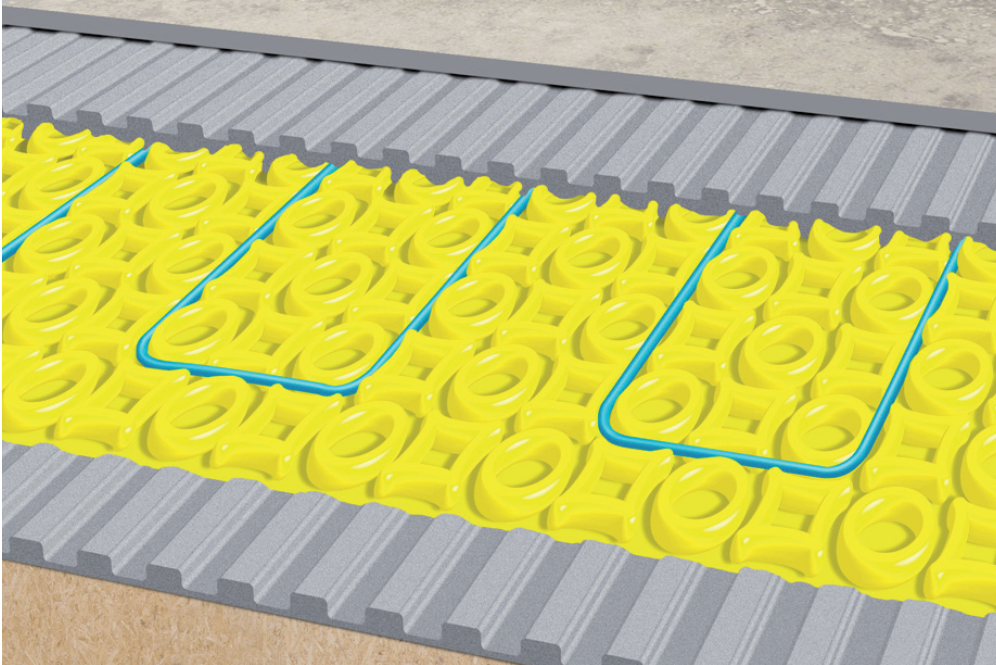

GENERAL

It is of vital importance that the installation of any underfloor heating system is preplanned. Care must be taken to understand the requirements of the heating system of your choice. The heating cable layout must be pre planned to avoid any “cross over’s”. The positioning of sensors and the power supply must be pre-determined.

For general room heating we recommend that cables be installed in the CI - FH membrane at 75mm.

DURABASE CI-FH PREPARATION

The sub floor must be free of any loose material that could impair adhesion. It must be level and able to bear weight. Any levelling must be completed before DURABASE CI-FH is installed. The adhesive should be chosen dependent on the nature of the sub floor. The adhesive must be capable of bonding to the sub floor surface and to the backing fleece of the DURABASE CI - FH mats.

Maintaining the stud pattern alignment, the CI-FH matting sections should be cut to size to cover the desired surface. If subject to heavy traffic it is recommended that they be protected from damage by over laying walk boards.

For most surfaces a water-based thin-bed adhesive (C2 quality) can be used. The adhesive is applied to the sub floor using a serrated trowel (6 x 6mm).

In wet areas it is advised to seal junctions between mat sections with DURABASE WP or DURABASE WPFB tape. Pre-formed corner sections can be used for internal and external corners.

Dural (UK) Ltd

Unit 6a, Wakefield Business Centre,
Denby Dale Road, Wakefield, West
Yorkshire, WF2 7AZ

Tel: +44 (0) 1924 360 110

Fax: +44 (0) 1924 360 660

Email: info@dural.co.uk

Durabase CI-FH

2/2

Installation
Instructions

DURAL

Decoupling mats for Electric Underfloor Heating

- INSTALLATION INSTRUCTIONS -

As soon as the DURABASE CI-FH matting has been installed and the adhesive has cured, the electrical heating system can be installed to the manufacturer's instructions.

Tiles can be installed using a thin-bed adhesive appropriate to the flooring. Practically, it is advisable to apply adhesive in one operation, embedding the heating cables in that process. Install the tiles after pre "buttering" the underside.

The tiles must be embedded in the adhesive to achieve solid bedding. The depth of the serrations on the trowel must be appropriate to the tile format. Make sure this is all done while the adhesive is still fresh and within its "open time".

Durabase CI-FH is not suitable for external use.

Where movement joints are required, follow professional guide lines – BS 5385. TTA Guidelines or contact our technical team.

NOTES

When used with 2mm cable it is advisable to incorporate a 3 stud locking loop every 30cm. This ensures the cable is retained under tension.

CI – FH is supplied in rolls of 15m and 5m. The nominal width of these is 1m.

Due to unavoidable trimming of the material to ensure the production pattern is maintained the width may be reduced by up to 25mm.

Suitable for heating cables of 2mm - 5.5mm

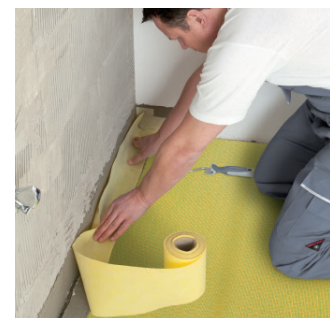
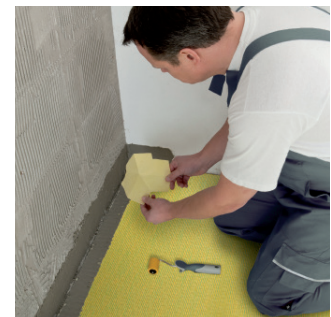
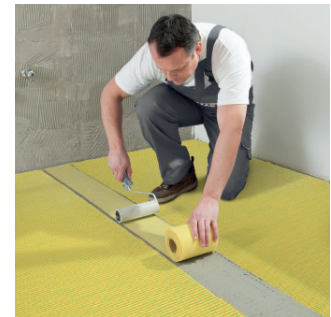

Dural (UK) Ltd

Unit 6a, Wakefield Business Centre,
Denby Dale Road, Wakefield, West
Yorkshire, WF2 7AZ
Tel: +44 (0) 1924 360 110
Fax: +44 (0) 1924 360 660
Email: info@dural.co.uk